

LOT LOCATION

This unique investment opportunity is located in phase one of Belmont and is surrounded by completed construction.

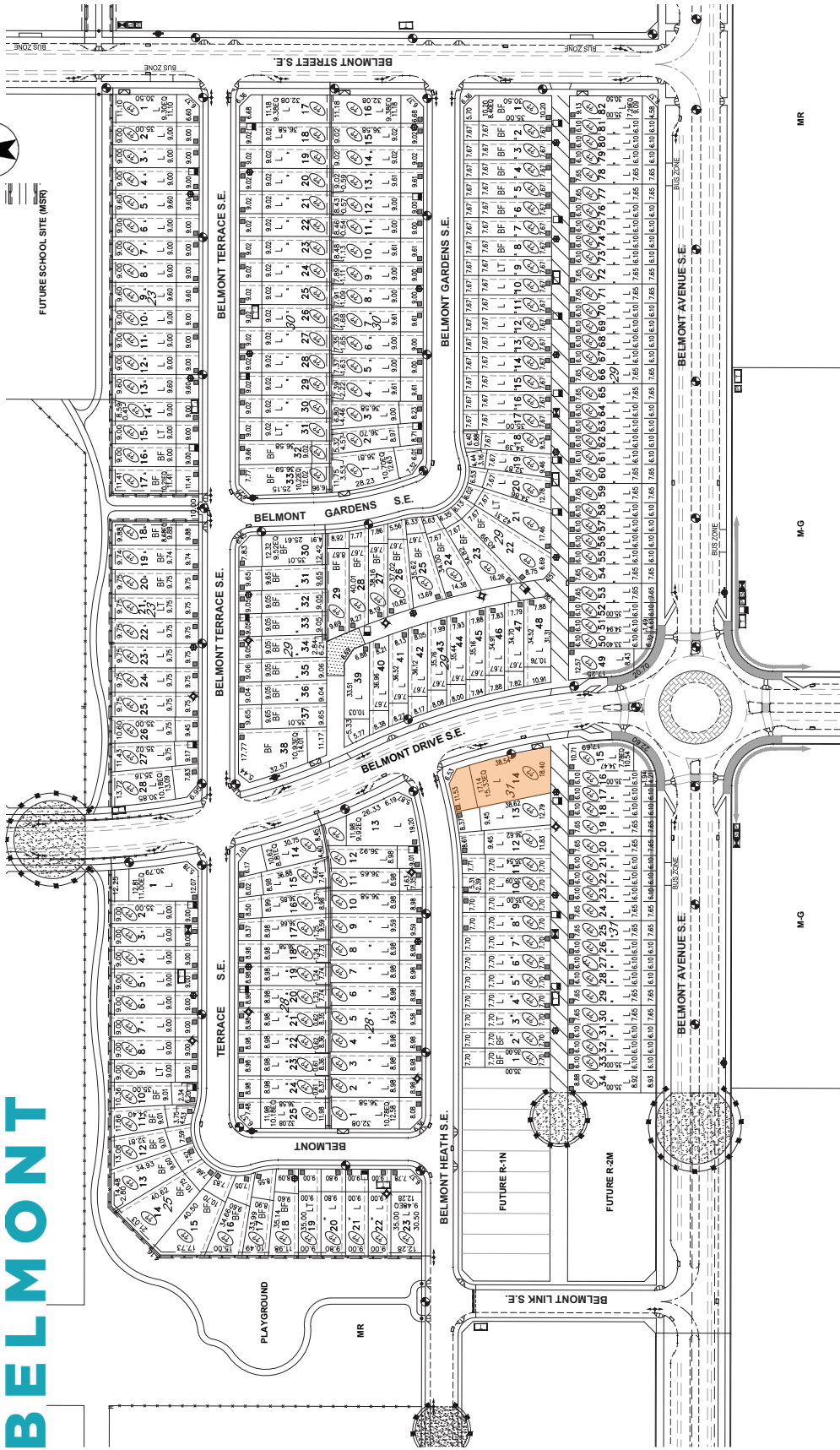

Legend

- L - LEVEL LOT
- WB - FULL WALKOUT BASEMENT
- WS - SPLIT LEVEL WALKOUT BASEMENT
- BF - LEVEL LOT (BACK TO FRONT DRAINAGE)
- T - TRANSITION LOT
- DR - DRIVEWAY LOCATION
- HY - HYDRANT
- SL - STREET LIGHT (PRELIMINARY)
- ST - STREET LIGHT (STANDARD)
- ET - ELECTRIC TRANSFORMER
- EC - ELECTRIC SWITCH CIRCLE
- EP - ELECTRIC PULLBOX
- CP - CABLE TV (PRELIMINARY)

THIS PLAN IS A CONCEPT ONLY AND MAY BE SUBJECT TO CHANGE WITHOUT NOTICE

- ☐ - CABLE TV PULLBOX (PRELIMINARY)
- ☐ - TELEPHONE PULLBOX (PRELIMINARY)
- ☐ - TELUS SERVICE VAULT (PRELIMINARY)
- ☐ - WOOD SCREEN FENCE
- ☐ - CHAIN LINK FENCE
- ☐ - COMMUNITY MAILBOX (PRELIMINARY)
- ☐ - MUNICIPAL ADDRESS
- ☐ - SLOPED LANDS
- ☐ - CONCRETE DRAINAGE SWALE
- ☐ - CONCRETE SPASH PAD
- ☐ - GRASS DRAINAGE SWALE
- ☐ - 1.5m MAINTENANCE ACCESS RIGHT OF WAY
- ☐ - PAVED LAINE

NOTES:
 FRONTAGES ARE APPROXIMATE ONLY. REFER TO LEGAL DESCRIPTIONS FOR ALL DIMENSIONS AND EASEMENTS. REFER TO UTILITY RIGHTS OF WAY AND EASEMENT DOCUMENTS TO DETERMINE RESTRICTIONS ON EXTENT OF TITLE.

WARNING:
 THIS IS NOT A LEGAL PLAN. DIMENSIONS, SETBACKS, WIDTHS, AND AREAS ARE APPROXIMATE. ALL DIMENSIONS, SETBACKS, WIDTHS, AND AREAS ARE SUBJECT TO CHANGE WITHOUT NOTICE. FOR VERIFICATION OF INFORMATION CALL 403-885-6180.

Comments to All Owners and Developers are the Property of Starlec Consulting Ltd. Reproduction or Use for Any Purpose Other Than That Authorized by Starlec Consulting Ltd. is Prohibited.

Client/Project: UNITED COMMUNITIES BELMONT PHASE 1

Title: Preliminary Sur 116527208.1.017

BELMONT



V:\116527208\116527208\Belmont_Visuals\Map\Map_01_Development_LotComponent116527208_116527208.dwg